

VACUUM CLEANER ZELMER TYPE 400.0.F16E

BLUE RAL 5024 / RED RAL 3016

ZELMER HUNGARY

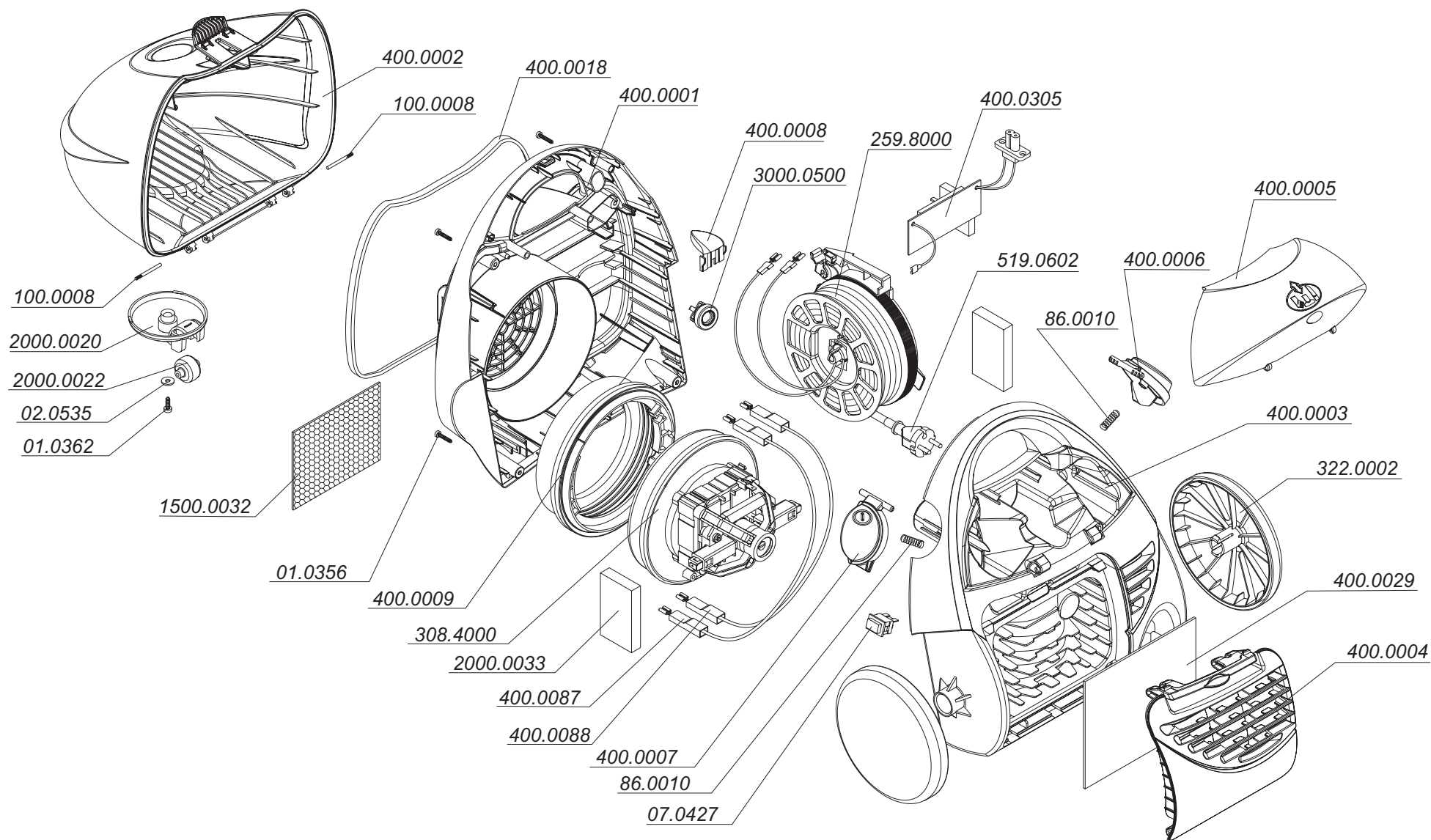

II SUCTION UNIT TYPE 308.4000

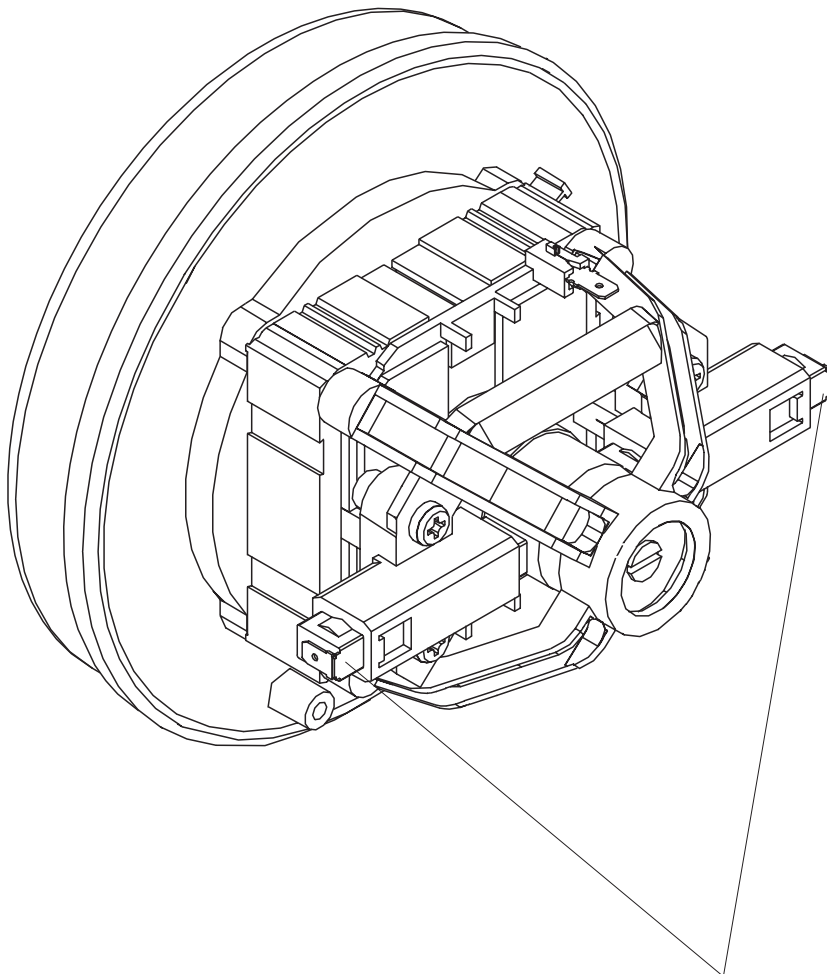

308.4210

||| CORD WINDER 259.8000

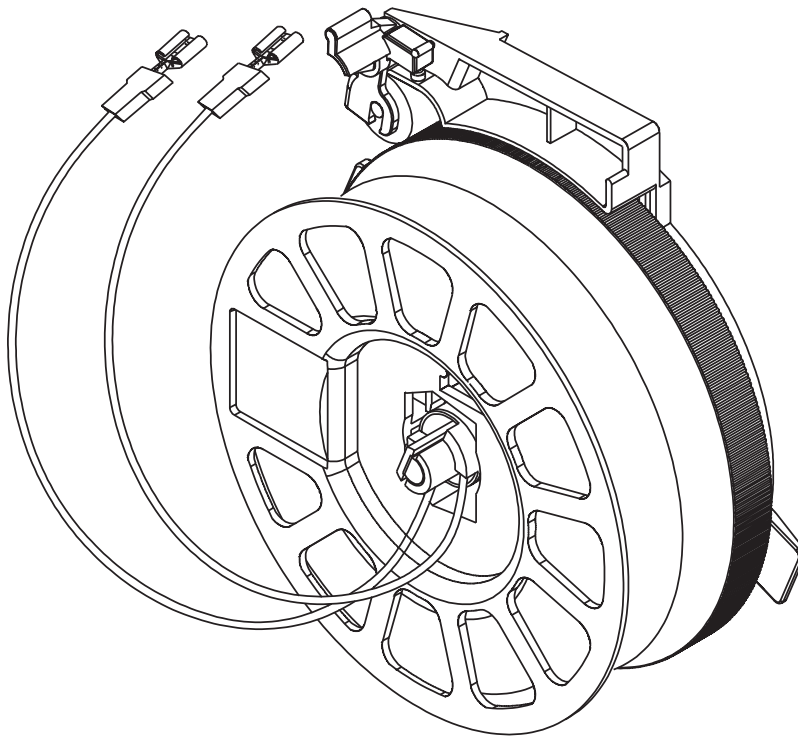

500.0701

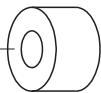

265.5004



159.5005



259.0003



IV VACUUM CLEANER ACCESSORIES ZELMER TYPE 400.0.F16E BLUE RAL 5024 / RED RAL 3016 ZELMER HUNGARY

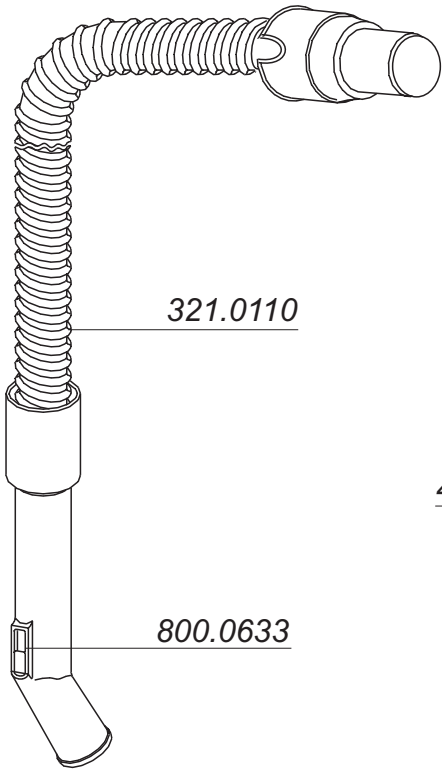

321.0110

800.0633

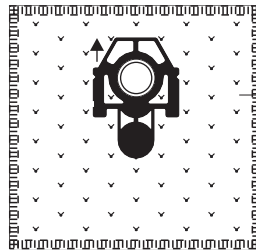

49.4000

49.9500

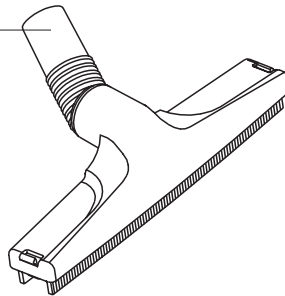

111.6000



449.0000

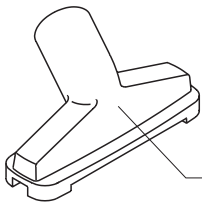
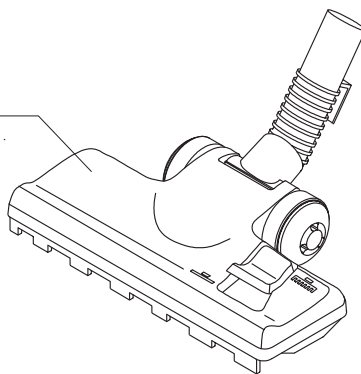

1020.0020



1020.0030

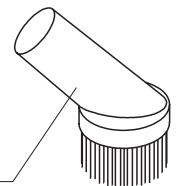

2010.0220

V ELECTRICAL DIAGRAM OF THE VACUUM CLEANER ZELMER TYPE 400.0.F16E ZELMER HUNGARY

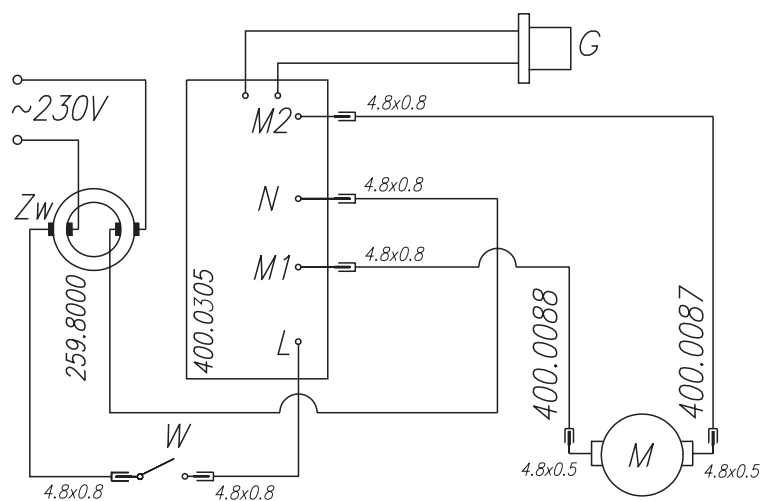

Zw - CORD WINDER
M - MOTOR
W - MAIN SWICH
G - ELECTROBRUSH - SOCKET

VI DISMANTLE OF VACUUM CLEANER TYPE 400

